

41687
CASE QUADTRAC 535
TRACTOR STALK STOMPER
MOUNT KIT

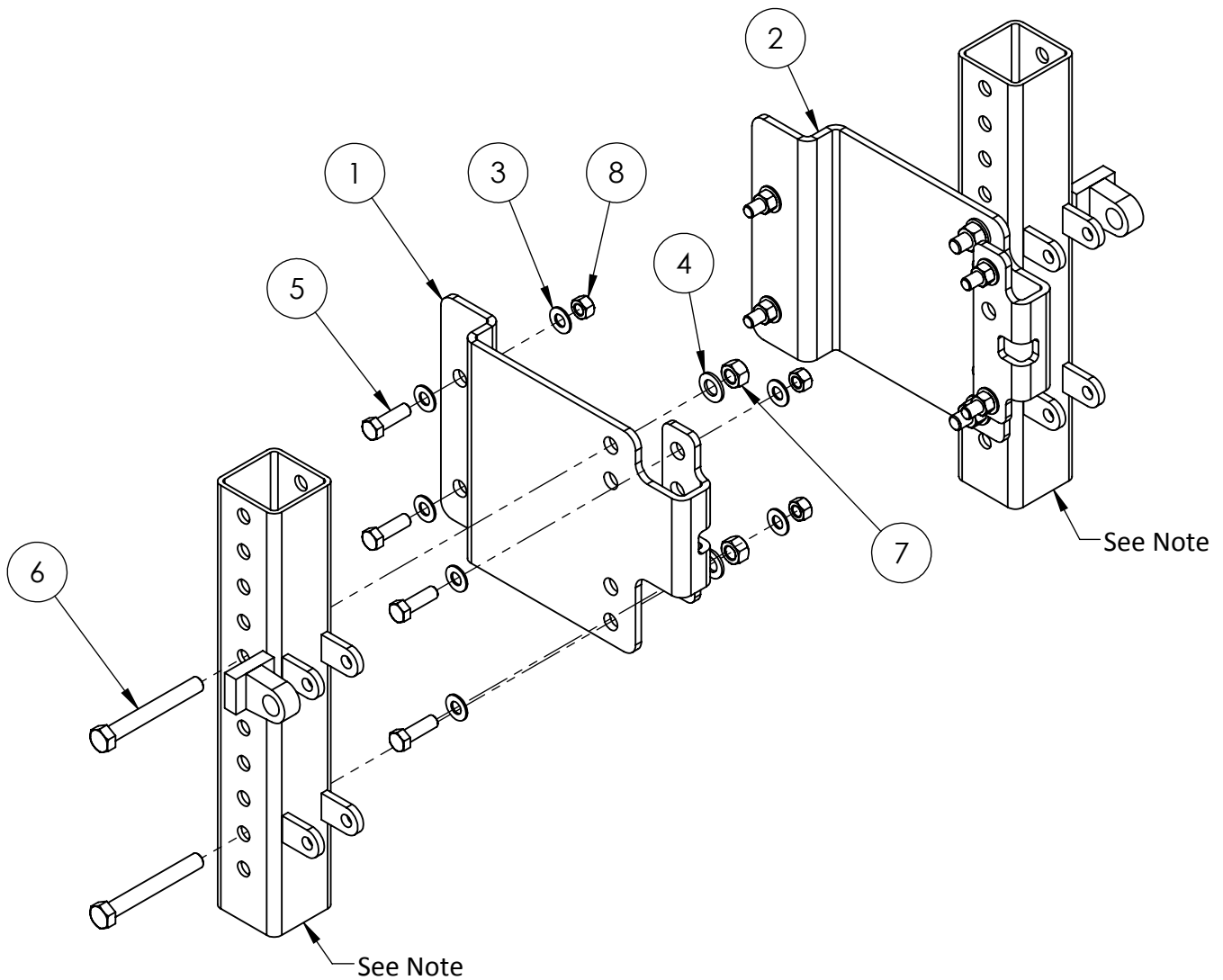

NOTE:
 -For graphical reference only. Vertical Mounts are included in the Lift Arm Assemblies.

ITEM#	PART#	DESCRIPTION	QTY	ITEM#	PART#	DESCRIPTION	QTY
1	22257	MOUNT PLATE (RIGHT)	1	5	00881	BOLT, 5/8"-11 X 2" HEX	8
2	22259	MOUNT PLATE (LEFT)	1	6	00033	BOLT, 3/4"-10 X 6" HEX	4
3	00234	WASHER, 5/8" FLAT SAE	16	7	00621	NUT, 3/4"-10 TOP LOCK	4
4	00238	WASHER, 3/4" FLAT SAE	4	8	00197	NUT, 5/8"-11 TOP LOCK	8



120 Eastgate Drive SE
PO Box 7
Hutchinson, MN 55350

1-800-788-6483
1-320-587-2322
1-320-587-6112 (Fax)

WWW.MAYWES.COM

41687
CASE QUADTRAC 535
TRACTOR STALK STOMPER
MOUNT KIT

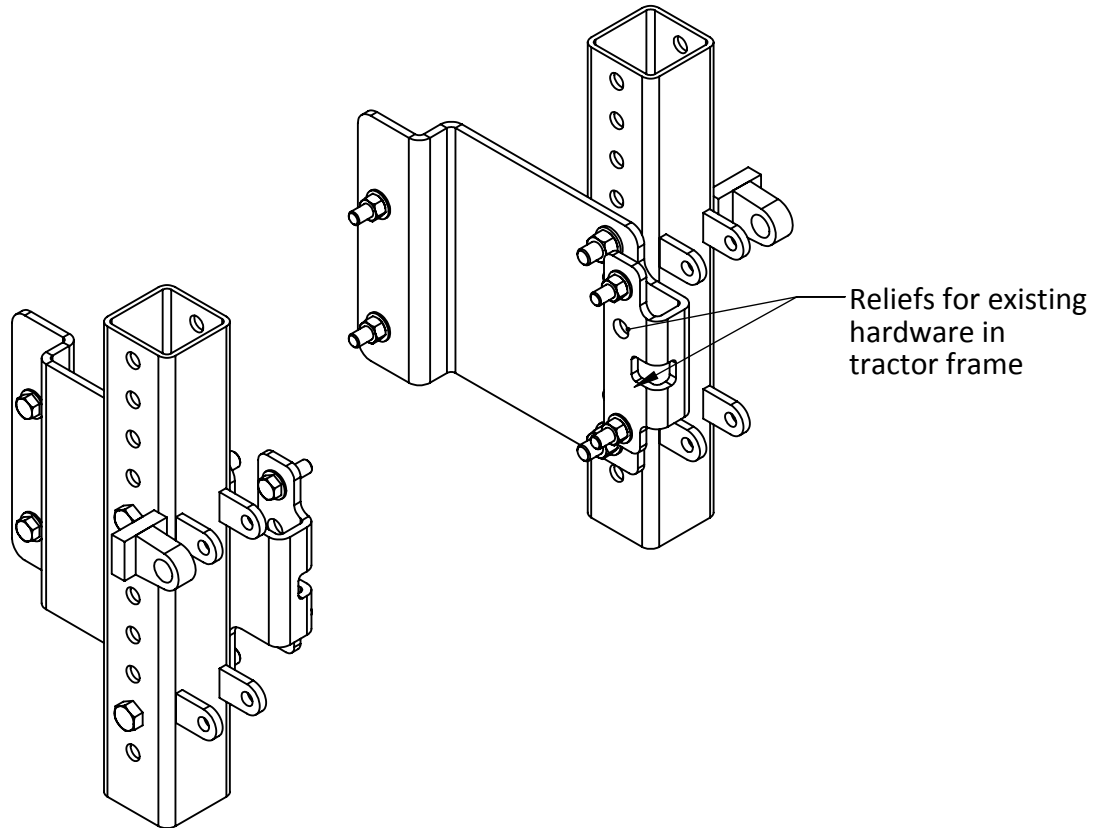

Safety Procedure:

-Park tractor on level ground and engage parking brake.

Installation Procedure:

- Remove toolbox and stair from tractor.
- Hold mount bracket #22257 up to the front right side of tractor frame matching the hole pattern in the bracket to existing hole locations in tractor frame. (Existing hardware may need to be removed from matching hole locations in tractor frame)
- Attach mount bracket to tractor using supplied 5/8" hardware.
- Repeat steps 2 through 4 using mount bracket #22259 for the front left side of tractor.
- Proceed to mounting the Lift Arm Assemblies using 3/4" hardware supplied with mount kit and instructions provided with each Lift Arm Kit.



120 Eastgate Drive SE
PO Box 7
Hutchinson, MN 55350

1-800-788-6483
1-320-587-2322
1-320-587-6112 (Fax)

WWW.MAYWES.COM